

DIAGRAM OF EXPLORATION LICENCE No.
HOLDER: SHOALHAVEN COAL PTY LTD
PARISHES: CULLEN BULLEN
COUNTY: ROXBURGH
SCALE 1:30,000

(ELA No. 5290)

REF MAPS: 8931-3-N

SUBJECT TO SURVEY

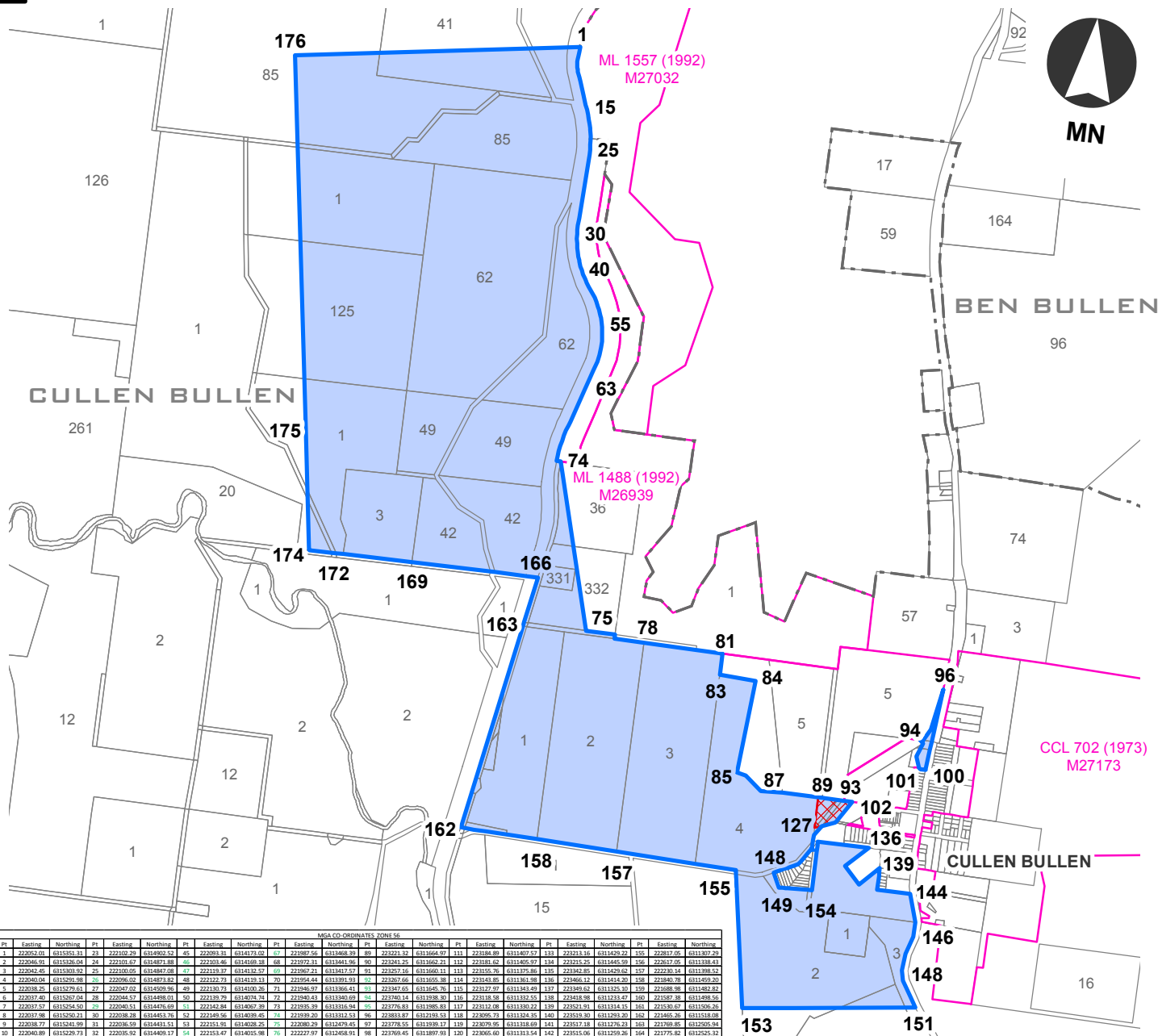
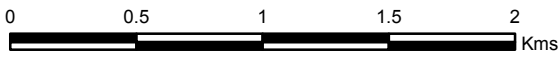

Table with 16 columns: P1, Easting, Northing, P2, Easting, Northing, P3, Easting, Northing, P4, Easting, Northing, P5, Easting, Northing, P6, Easting, Northing, P7, Easting, Northing. It lists MGA CO-ORDINATES for various points.

- SURFACE / DEPTH RESTRICTION
Embraces the surface & soil below thereof to a depth of 900 metres below Australian Height Datum (AHD).
Embraces the strata between a depth of 15.24 metres below the surface to 900 metres below AHD.

Co-ordinate points coloured green determined by survey.
Co-ordinate values for:
Pts 26, 29, 35, 39, 42, 46, 47, 51, 54, 55, 60, 62, 65, 67, 69, 74 from M27032
Pts 75, 76, 77, 80 from M26939
Pts 81, 82, 84-88, 92-95 from M26886

UNIVERSAL TRANSVERSE MERCATOR PROJECTION
HORIZONTAL DATUM: GDA94



AREA: abt.552 ha

Prepared by: S Collins
Date: 27-05-2016
Approved by: P Hord
Date: 11-07-2016
Maitland Regional Office

DISCLAIMER: The compilation of information shown on this diagram is derived from plans and data, some of which has been produced and provided by third parties. Title boundaries have been adjusted to maintain their relationship with the digital cadastral database in some circumstances, thereby creating certain inaccuracies in the data. The Department and the State of New South Wales make no statement, representation or warranty that the titles information shown on this diagram is complete, accurate or free from error. Users rely on the titles information supplied on this diagram at their own risk.