

RESOURCES & ENERGY

File: 16-0849

DIAGRAM OF EXPLORATION LICENCE No.
HOLDER: SHOALHAVEN COAL PTY LTD
PARISHES: BEN BULLEN & CULLEN BULLEN
COUNTY: ROXBURGH
SCALE 1:30,000

(ELA No. 5289)

REF MAPS: 8931-3-N

SUBJECT TO SURVEY

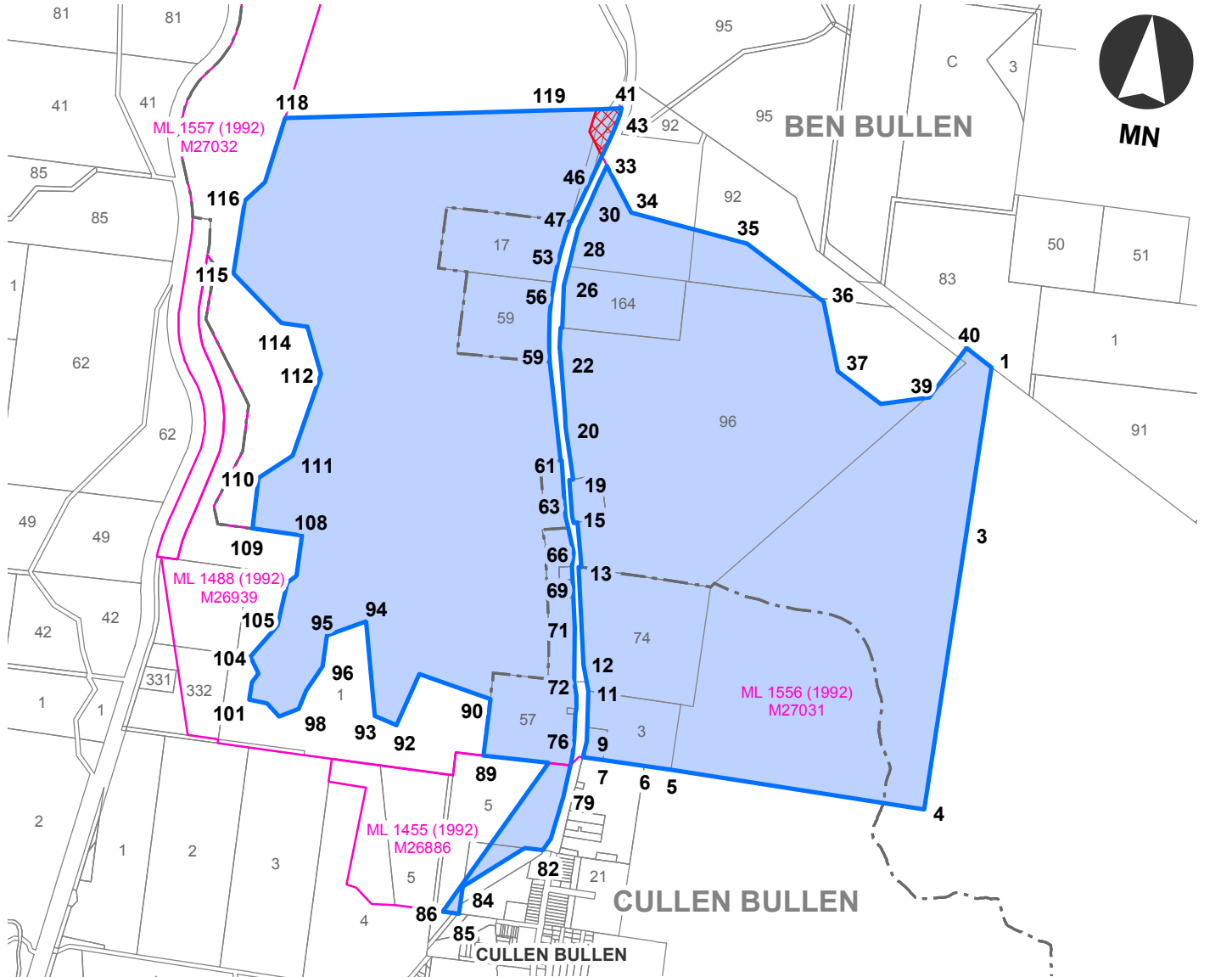

SURFACE / DEPTH RESTRICTION

 Embraces the surface & soil below thereof to a depth of 15 metres.

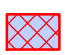
 Embraces the strata between a depth of 20 metres below the surface to 900 metres below Australian Height Datum.

MGA CO-ORDINATES ZONE 56											
Pt	Easting	Northing	Pt	Easting	Northing	Pt	Easting	Northing	Pt	Easting	Northing
1	225836.14	6314200.33	21	223840.99	6313978.74	41	224106.96	6315409.95	61	223821.79	6313764.77
2	225828.31	6314151.83	22	223823.25	6314217.18	42	224098.97	6315378.73	62	223826.28	6313765.06
3	225718.62	6313433.56	23	223817.45	6314295.24	43	224087.55	6315350.37	63	223840.37	6313567.74
4	225520.63	6312137.12	24	223822.82	6314385.20	44	224080.31	6315332.40	64	223845.00	6313503.48
5	224312.63	6312320.97	25	223829.92	6314384.40	45	224064.82	6315293.95	65	223856.91	6313450.46
6	224212.79	6312339.63	26	223836.28	6314383.97	46	223966.23	6315084.33	66	223882.78	6313335.37
7	224019.01	6312367.43	27	223858.85	6314672.64	47	223871.81	6314885.93	67	223875.22	6313269.99
8	223925.31	6312380.75	28	223882.92	6314767.30	48	223870.42	6314882.45	68	223877.75	6313211.03
9	223943.40	6312452.65	29	223903.39	6314847.76	49	223866.49	6314882.89	69	223879.25	6313176.67
10	223945.63	6312518.76	30	223953.77	6314963.62	50	223855.04	6314842.82	70	223880.46	6313150.84
11	223951.25	6312688.22	31	223970.59	6314999.54	51	223842.86	6314808.51	71	223887.70	6312984.39
12	223927.50	6312810.96	32	224000.35	6315062.76	52	223837.66	6314790.67	72	223884.37	6312743.38
13	223905.37	6313268.85	33	224036.64	6315144.12	53	223817.29	6314720.74	73	223895.85	6312669.43
14	223917.91	6313266.96	34	224150.58	6314922.95	54	223796.88	6314631.69	74	223895.37	6312605.06
15	223900.19	6313477.16	35	224666.09	6314785.62	55	223791.38	6314598.89	75	223889.27	6312579.43
16	223882.39	6313473.69	36	225050.72	6314507.56	56	223781.82	6314541.45	76	223884.14	6312461.50
17	223874.80	6313507.89	37	225116.51	6314181.97	57	223772.10	6314450.47	77	223876.39	6312386.46
18	223862.90	6313673.74	38	225116.46	6314030.67	58	223767.79	6314359.21	78	223871.90	6312333.63
19	223880.71	6313677.15	39	225434.59	6314059.34	59	223768.99	6314267.77	79	223833.87	6312193.53
20	223844.96	6313923.55	40	225717.99	6314290.13	60	223772.09	6314224.56	80	223830.59	6312192.20

Co-ordinate points coloured green determined by survey.

Co-ordinate values for:

Pts 78, 80, 81, 82, 83, 84, 85, 86, 88 from M26886

Pts 2-5, 89-120 from M27031

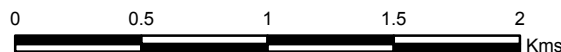

UNIVERSAL TRANSVERSE MERCATOR PROJECTION
 HORIZONTAL DATUM: GDA84

AREA: abt.808 ha

Prepared by: S Collins
 Date: 27-05-2016
 Approved by: P Hord
 Date: 11-07-2016
 Maitland Regional Office

DISCLAIMER: The compilation of information shown on this diagram is derived from plans and data, some of which has been produced and provided by third parties. Title boundaries have been adjusted to maintain their relationship with the digital cadastral database in some circumstances, thereby creating certain inaccuracies in the data. The Department and the State of New South Wales make no statement, representation or warranty that the titles information shown on this diagram is complete, accurate or free from error. Users rely on the titles information supplied on this diagram at their own risk. The Department and the State of New South Wales accept no responsibility for any person, acting on, or relying on, or upon any of the titles information shown on this diagram, and disclaim all liability for any loss, damage, cost, expense or injury (including death) incurred or arising by reason of any person using or relying on the titles information contained on this diagram by reason or by any error, omission, defect or misstatement (whether such error, omission or misstatement is caused by or arises from negligence, lack of care or otherwise). Users should always verify historical material by making and relying upon their own separate inquiries prior to making any important decisions or taking any action on the basis of titles information.