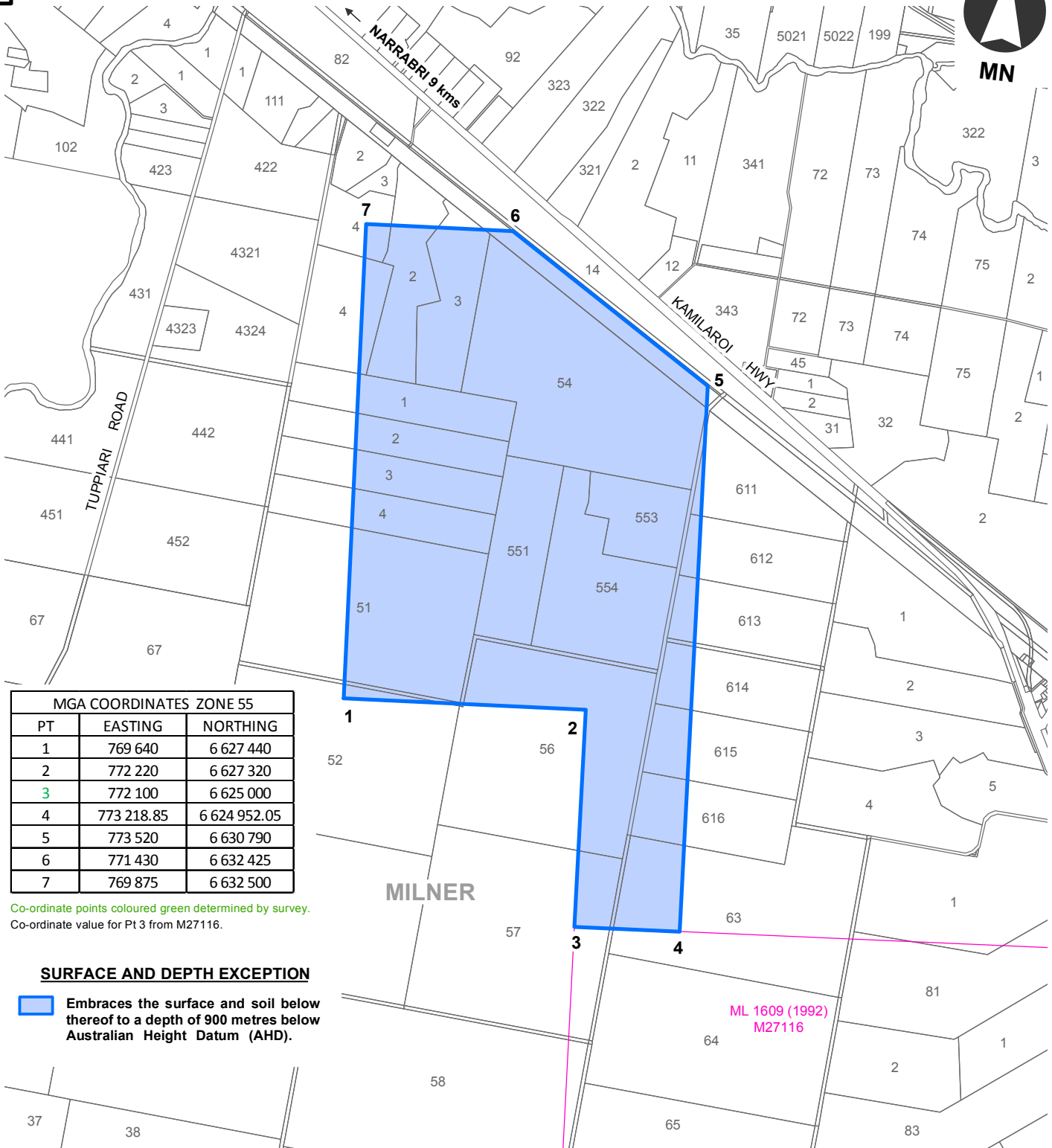

**DIAGRAM OF EXPLORATION LICENCE No.  
 HOLDER: NARRABRI COAL PTY LTD & OTHERS  
 PARISH: MILNER  
 COUNTY: WHITE  
 SCALE 1: 60000**

**(ELA No.5397)**

**REF MAPS: 8837-2-S**

**SUBJECT TO SURVEY**



MGA COORDINATES ZONE 55		
PT	EASTING	NORTHING
1	769 640	6 627 440
2	772 220	6 627 320
3	772 100	6 625 000
4	773 218.85	6 624 952.05
5	773 520	6 630 790
6	771 430	6 632 425
7	769 875	6 632 500

Co-ordinate points coloured green determined by survey.  
 Co-ordinate value for Pt 3 from M27116.

**SURFACE AND DEPTH EXCEPTION**

Embraces the surface and soil below thereof to a depth of 900 metres below Australian Height Datum (AHD).

UNIVERSAL TRANSVERSE MERCATOR PROJECTION  
 HORIZONTAL DATUM: GDA84

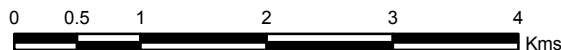

**AREA: abt. 1974 ha**

**Prepared by: S Grace  
 Date: 25-11-2016  
 Approved by: P Hord  
 Date: 09-01-2017  
 Drafting Services  
 Operations & Programs**

**DISCLAIMER:** The compilation of information shown on this diagram is derived from plans and data, some of which has been produced and provided by third parties. Title boundaries have been adjusted to maintain their relationship with the digital cadastral database in some circumstances, thereby creating certain inaccuracies in the data. The Department and the State of New South Wales make no statement, representation or warranty that the titles information shown on this diagram is complete, accurate or free from error. Users rely on the titles information supplied on this diagram at their own risk. The Department and the State of New South Wales accepts no responsibility for any person, acting on, or relying on, or upon any of the titles information shown on this diagram, and disclaim all liability for any loss, damage, cost, expense or injury (including death) incurred or arising by reason of any person using or relying on the titles information contained on this diagram by reason of or by any error, omission, defect or misstatement (whether such error, omission or misstatement is caused by or arises from negligence, lack of care or otherwise). Users should always verify historical material by making and relying upon their own separate inquiries prior to making any important decisions or taking any action on the basis of titles information.